

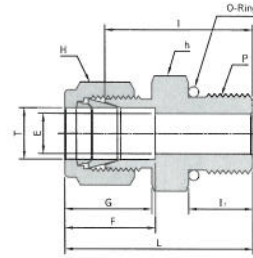

SAE Male Connector
UMCS



Connects Fractional Tube to SAE Straight Thread Boss

Part No.	Tube O.D. T		Straight Thread P(U)	E Min	h		H		F	G	l	l ₁	L
	in	mm			in	mm	in	mm					
02UMCS-02U	1/8	3.17	5/16-24	2.3	7/16	11.11	7/16	11.11	12.7	15.2	23.3	7.6	30.0
04UMCS-04U	1/4	6.35	7/16-20	4.8	9/16	14.28	9/16	14.28	15.2	17.8	26.7	9.1	34.0
04UMCS-06U	1/4	6.35	9/16-18	4.8	11/16	17.46	9/16	14.28	15.2	17.8	28.2	9.9	35.6
04UMCS-08U	1/4	6.35	3/4-16	4.8	7/8	22.22	9/16	14.28	15.2	17.8	30.2	11.2	37.6
04UMCS-10U	1/4	6.35	7/8-14	4.8	1	25.40	9/16	14.28	15.2	17.8	33.3	12.7	40.6
05UMCS-05U	5/16	7.93	1/2-20	6.0	5/8	15.87	5/8	15.87	16.3	18.5	27.4	9.1	34.8
06UMCS-04U	3/8	9.52	7/16-20	5.0	5/8	15.87	11/16	17.46	16.8	19.3	28.2	9.1	35.6
06UMCS-06U	3/8	9.52	9/16-18	7.0	11/16	17.46	11/16	17.46	16.8	19.3	29.7	9.9	37.1
06UMCS-08U	3/8	9.52	3/4-16	7.0	7/8	22.22	11/16	17.46	16.8	19.3	31.8	11.2	39.1
06UMCS-10U	3/8	9.52	7/8-14	7.0	1	25.40	11/16	17.46	16.8	19.3	34.8	12.7	42.2
08UMCS-06U	1/2	12.70	9/16-18	7.0	13/16	20.63	7/8	22.22	22.9	21.8	29.0	9.9	39.1
08UMCS-08U	1/2	12.70	3/4-16	10.0	7/8	22.22	7/8	22.22	22.9	21.8	31.8	11.2	41.9
08UMCS-10U	1/2	12.70	7/8-14	10.0	1	25.40	7/8	22.22	22.9	21.8	34.8	12.7	45.0
08UMCS-12U	1/2	12.70	1-1/16-12	10.0	1-1/4	31.75	7/8	22.22	22.9	21.8	38.9	15.0	49.0
10UMCS-08U	5/8	15.87	3/4-16	10.0	15/16	23.81	1	25.40	24.4	21.8	31.8	11.2	41.9
10UMCS-10U	5/8	15.87	7/8-14	12.0	1	25.40	1	25.40	24.4	21.8	35.1	12.7	45.2
12UMCS-08U	3/4	19.05	3/4-16	10.0	1-1/16	26.98	1-1/8	28.57	24.4	21.8	35.8	11.2	46.0
12UMCS-12U	3/4	19.05	1-1/16-12	16.0	1-1/4	31.80	1-1/8	28.57	24.4	21.8	38.9	15.0	49.0
14UMCS-14U	7/8	22.22	1-3/16-12	18.0	1-3/8	34.92	1-1/4	31.75	25.9	21.8	38.9	15.0	49.0
16UMCS-12U	1	25.40	1-1/16-12	16.0	1-3/8	34.92	1-1/2	38.10	31.2	26.4	41.1	15.0	53.3
16UMCS-16U	1	25.40	1-5/16-12	22.0	1-1/2	38.10	1-1/2	38.10	31.2	26.4	42.2	15.0	54.4



*Positionable
SAE Male Elbow*
UMES

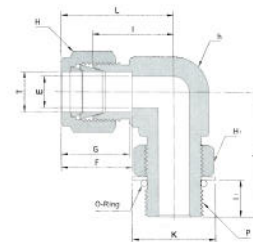

Connects Fractional Tube to SAE Straight Thread Boss

Part No.	Tube O.D. T		Straight Thread P(U)	E min	h		H		H ₁		F	G	l	l ₁	L	L ₁	K
	in	mm			in	mm	in	mm	in	mm							
04UMES-04U	1/4	6.35	7/16-20	4.8	1/2	12.70	9/16	14.28	9/16	14.28	15.2	17.8	21.1	9.9	28.4	28.4	16.5
05UMES-05U	5/16	7.93	1/2-20	6.0	9/16	14.28	5/8	15.87	5/8	15.87	16.2	18.5	22.9	9.9	30.2	29.5	18.3
06UMES-06U	3/8	9.52	9/16-18	7.0	5/8	15.87	11/16	17.46	11/16	17.46	16.8	19.3	24.6	11.2	32.0	32.3	20.1
06UMES-08U	3/8	9.52	3/4-16	7.0	13/16	20.63	11/16	17.46	7/8	22.22	16.8	19.3	27.4	12.7	34.8	37.8	25.7
08UMES-08U	1/2	12.70	3/4-16	10.0	13/16	20.63	7/8	22.22	7/8	22.22	22.9	21.8	27.4	12.7	37.6	37.8	25.7
10UMES-10U	5/8	15.87	7/8-14	12.0	1	25.40	1	25.40	1	25.40	24.9	21.8	29.5	14.2	39.6	43.4	29.5
12UMES-12U	3/4	19.05	1-1/16-12	16.0	1-1/16	26.98	1-1/8	28.57	1-1/4	31.75	24.9	21.8	31.2	16.8	41.4	48.8	36.6
14UMES-14U	7/8	22.22	1-3/16-12	18.0	1-1/4	31.75	1-1/4	31.75	1-3/8	34.92	25.9	21.8	33.0	16.8	43.2	50.6	40.4
16UMES-16U	1	25.40	1-5/16-12	22.0	1-3/8	34.92	1-1/2	38.10	1-1/2	38.10	31.2	26.4	38.4	16.8	50.5	53.6	43.9

Note : Dimensions are reference only, subject to change without prior notice. F,G and L are typical finger tight.